

# Square Gibs - Inch

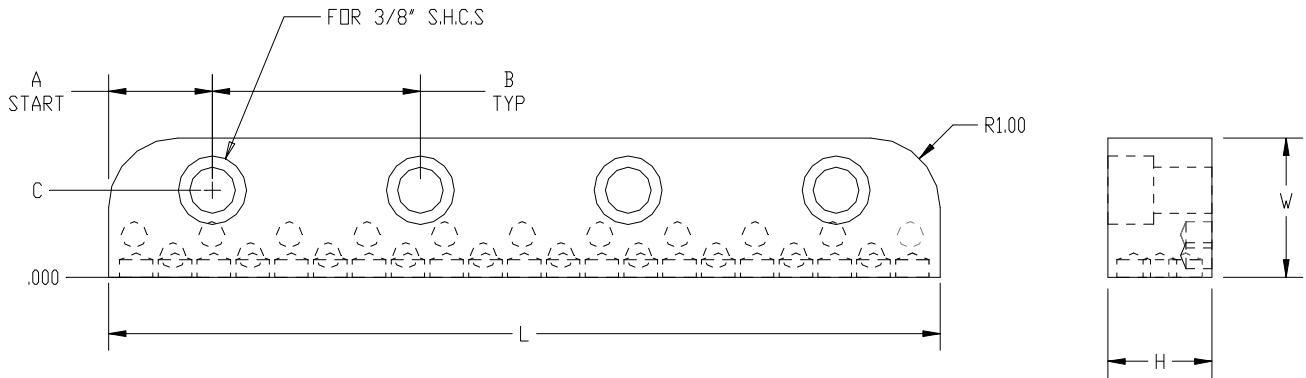

Material: Solid Bronze

Self Lube Plugs: Y N

- LIST ALL REQUIRED DIMENSIONS AND TOLERANCES.
- IF NO TOLERANCE IS SPECIFIED, THEN THE STANDARD CATALOG TOLERANCE WILL BE USED
- ALL SELF LUBE PRODUCTS HAVE 20-30% COVERAGE

	Description	Required Dimension				Required Tolerance
		A	B	C	# of Holes	
A-C	Mounting Hole Locations					/
W	Overall Width					/
L	Overall Length					/
H	Overall Height					/

Quantity Required: \_\_\_\_\_

Special Requirements:

## Contact Information:

Customer:			
Contact Name:			
Phone:		FAX:	
E-Mail:			